

THE GREAT
SEWING
adventure
ACROSS NEW ENGLAND

Furbaby Charging Station

22" x 36"

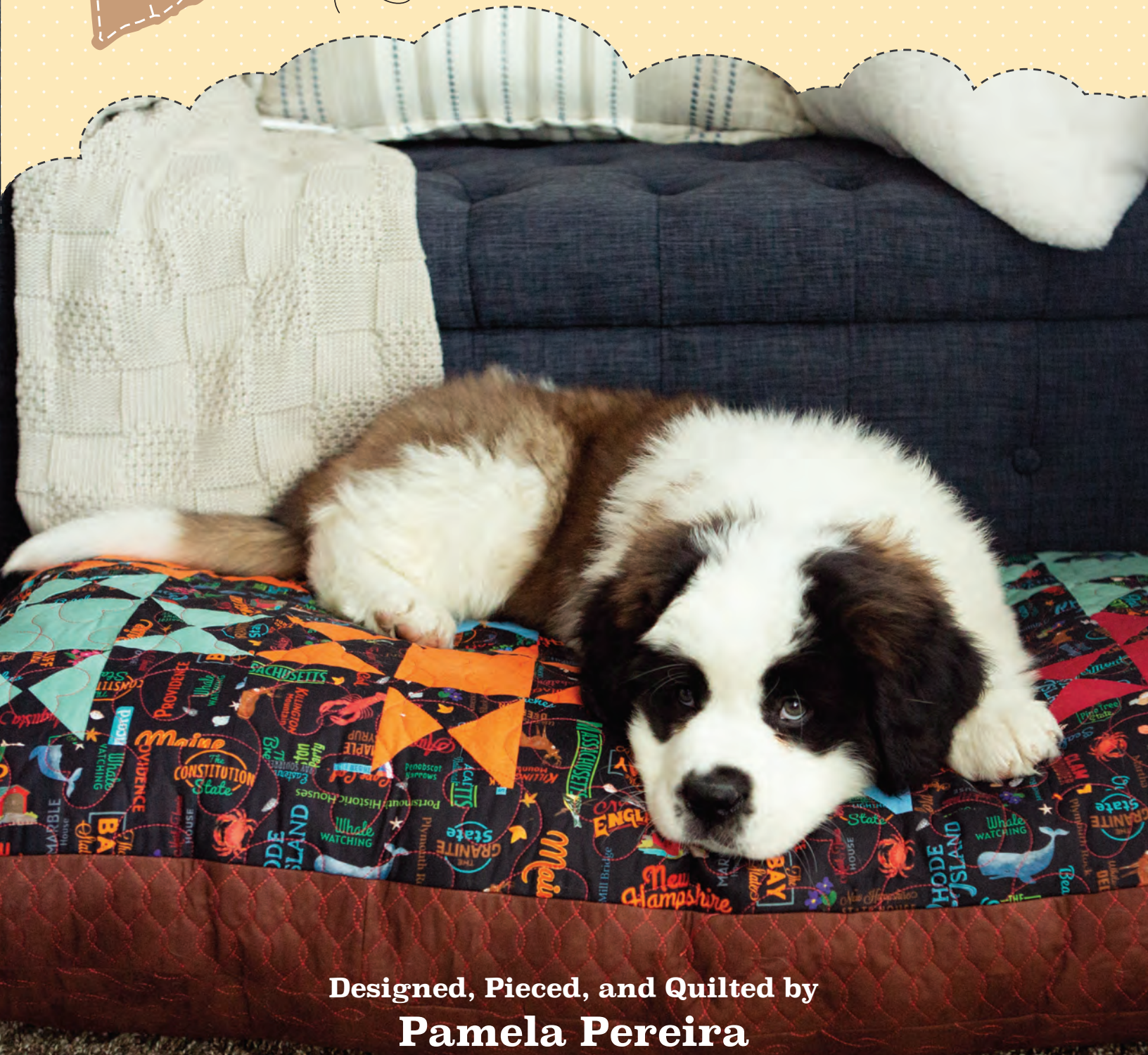

Designed, Pieced, and Quilted by
Pamela Pereira

MATERIALS:

- 1 yard Words Black
- 1/4 yard Blender Red
- 1/4 yard Blender Sage
- 1/4 yard Blender Orange
- 1/4 yard Blender Blue
- 1-1/4 yard Blender Brown
- 2-1/4 Muslim for lining
- 2-1/4 yard Batting
- [3] 32 oz. bags of Fiber Fill
- 9" zipper - optional but highly recommended for ease of turning and removing/adding fill when laundering

READ THROUGH ALL INSTRUCTIONS BEFORE BEGINNING. SEW PIECES RIGHT SIDES TOGETHER (RST) AND USE A 1/4" SEAM ALLOWANCE THROUGHOUT. WOF = WIDTH OF FABRIC; WS = WRONG SIDE OF FABRIC; RST = RIGHT SIDES TOGETHER

CUTTING INSTRUCTIONS:

From Blender Black Fabric:

- Cut [2] — 3-1/2" × WOF strips for border
- Cut [2] — 1-1/2" × WOF strips for border
- Cut [2] — 4-1/2" × WOF strips for stars
 - Subcut [16] — 4-1/2" squares. Cut diagonally twice, in an X, to create [64] triangles
- Cut [3] — 3-1/2" × WOF strips for stars
 - Subcut [32] — 3-1/2" squares

From each of the Blender Red, Sage, Orange and Blue Fabric:

- Cut [1] — 4-1/2" × WOF strips for stars
 - Subcut [4] — 4-1/2" squares. Cut diagonally twice, in an X, to create [16] triangles
- Cut [2] — 3-1/2" squares

ASSEMBLY:

1. Sew [8] Words Black triangles and [8] Blender Red triangles along short sides to make [8] pairs; press to the Black.



2. Join the pairs to make [4] Hourglass units.



3. Press seams open and trim to 3-1/2" squares. Create a 9-patch unit using the [4] Hourglass units, [1] Blender Red 3-1/2" square and [4] Black Word 3-1/2" squares.



4. Press seams open and trim to 9-1/2". Repeat to create a second Black/Blender Red 9-patch unit.
5. Follow same procedure to create [2] Black/Blender Sage 9-patch units, [2] Black/Blender Orange 9-patch units and [2] Black/Blender Blue 9-patch units.
6. Lay the eight 9-patch units out to make [2] rows of [4] units. After sewing the units in each row together press the seams in [1] row to the right and in the other row to the left.
7. Sew the rows together, nesting the seams. Press center seam open.

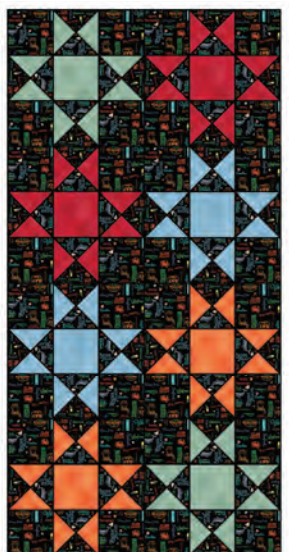

8. Sew a Words Black 3-1/2" border strip to the long sides of the rows, trim to fit and press toward the borders.
9. Sew a Words Black 1-1/2" border strip to the short sides of the rows, trim to fit and press toward the borders.
10. Cut a piece of muslin and a piece of batting to match the size of the pieced top, layer and quilt as you desire. Stay stitch 1/8" around perimeter. This top should measure approximately 24-1/2" x 38-1/2".
11. Layer the full 1-1/4 yard of Blender Brown with batting and Muslin, quilt as you desire.
12. Cut the quilted Blender Brown piece into [1] 27" x WOF rectangle (bottom), [1] 4" x 13" strip (zipper section of gusset) and [1] 3-1/2" x WOF strips (gusset). Stay stitch 1/8" around perimeter of each piece.
13. Lay the top on the bottom and trim them to match. Use a 4 inch circle (glass, plate, etc.) to make a rounded edge at the corners of both. Mark with chalk and cut with scissors.
14. Stay stitch 1/8" on those curves.



ASSEMBLY:

1. **Zipper insertion:** Cut the Blender Brown 4" x 13" quilted piece in half lengthwise and stay stitch the cut edges. With cut edges RST stitch 1-1/2" from [1] end at a tight stitch length, backstitch to secure and then increase to a basting stitch for the next 8-1/2". Decrease stitch length again, stitch a bit, backstitch to secure and continue to the end and backstitch. Press this seam open.

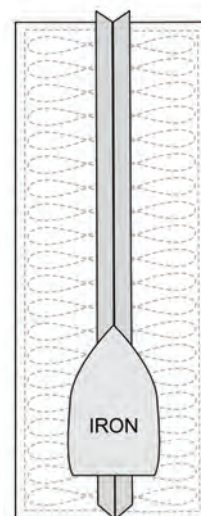

2. Place the zipper face down centered on the basted section of the seam and stitch in place remembering to stitch across both ends.

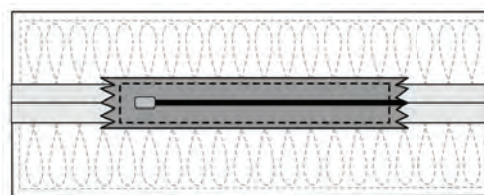

3. Open the basting stitches and make sure your zipper works and is fully accessible.

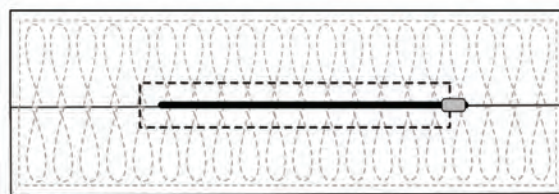

4. **Gusset:** Connect the zipper segment to the rest of the Blender Brown 3-1/2" quilted strips and add more strips until you have enough to go around the perimeter of the bottom piece — approximately 128". Position the zipper section, right sides together, on a long side of the quilted bottom and sew the gusset strip into place along the sides and around the curved corners leaving a tail un-sewn at both ends.

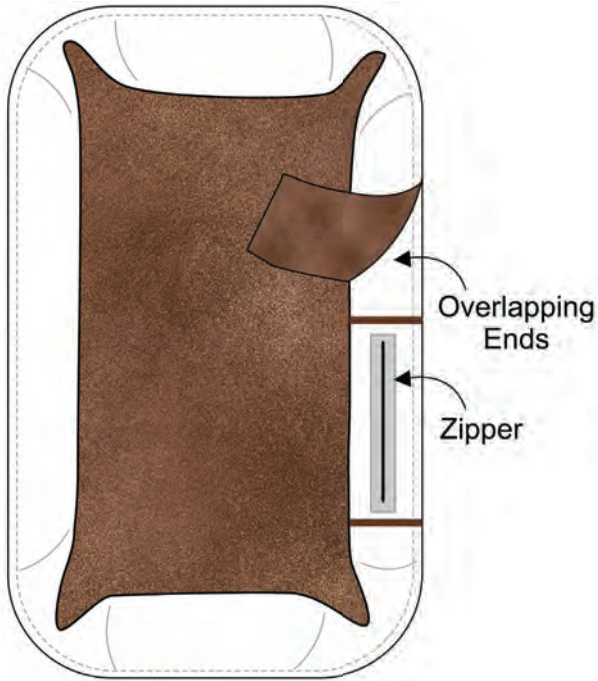

6. Adding the top: **OPEN THE ZIPPER ALL THE WAY.** This will allow you to turn the piece once the top is sewn in place. With right sides together, pin or clip the quilted top to the gusset, matching the edges and easing the corners.

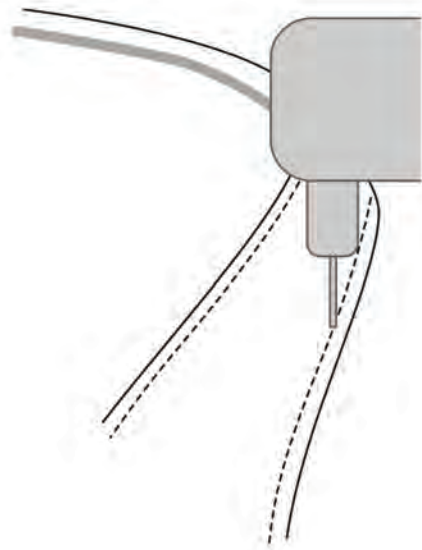

5. Bring the tails together, mark a seam line and sew on that marked line. Check that the gusset fits well and trim the seam to 1/2". Press open and complete stitching the gusset to the bottom.

7. Sew around the entire perimeter and turn the bed right side out using the opening created by the zipper. Reach inside and push out the edges and curves before stuffing. You're done!

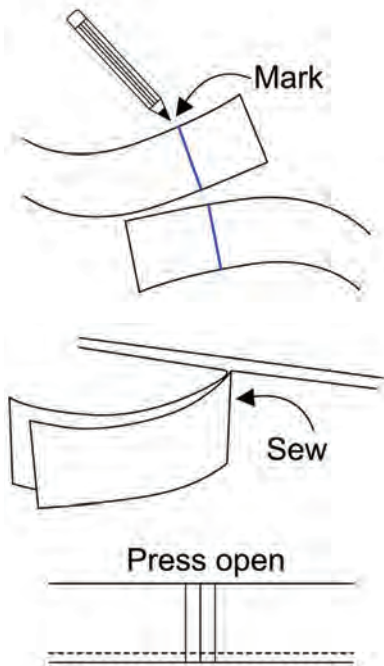



Pamela Pereira

Pamela has been sewing since age twelve when she dusted off her mother's Singer and began to make her own clothes. At eighteen, her grandmother gave her a new sewing machine, and Pamela made her first quilt. She has been an avid sewist ever since and has sewn clothing, quilts, and everything in between. Over the years, she has taught others the craft and continues to collaborate with the Blackstone Quilting Company in RI to design and teach classes. Most often, you can find her participating in shop hops and sewing retreats as well as attending sewing and quilt expos. Pamela feels blessed to have amazing support from her two adult children, family, and friends. She credits her late husband for the encouragement to pursue her passion.